

T250D

Features

- World first dome super tweeter employing $\varnothing 25\text{mm}$ pure magnesium diaphragm.
- Low distortion and high power magnetic circuit by combination of the copper-plating yoke/plate and the tripled $\varnothing 90\text{mm}$ large ferrite magnets.
- Up down roll tangential surround is equipped to realize the less anti-resonance and superior amplitude characteristic.
- Wide range and high input designing.
- High-density resin frame with the designed shape for woofer neighboring layout.



Specifications

Impedance : 8Ω

Reproduction Frequency Response : 900Hz - 50kHz

S.P.L. : 90dB/W (1m)

Power Handling : 150W (Music)

Recommended Crossover Frequency : 1.5kHz or more (-12dB/oct)

Magnet Weight : 329g x 1, / 403g x 2

Net Weight : 2,600g

Frequency Response

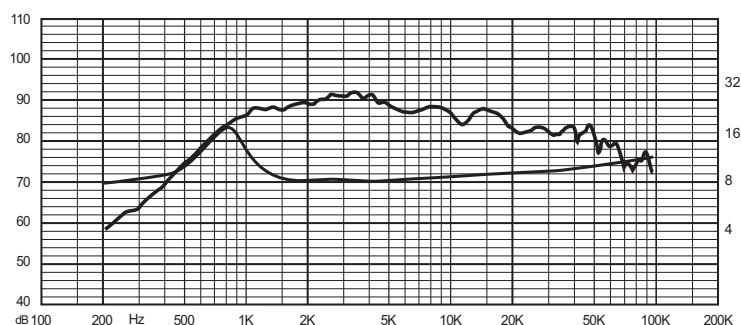

Dimensions

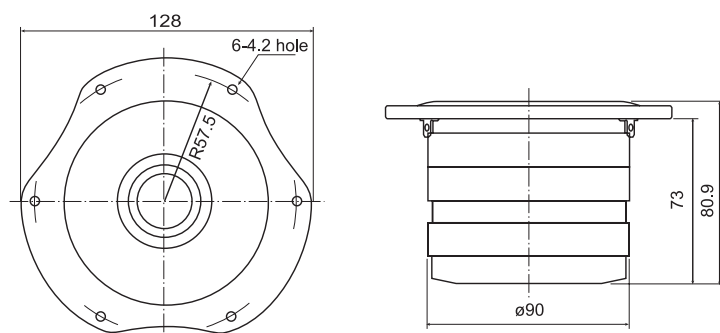

Mounting Information

